

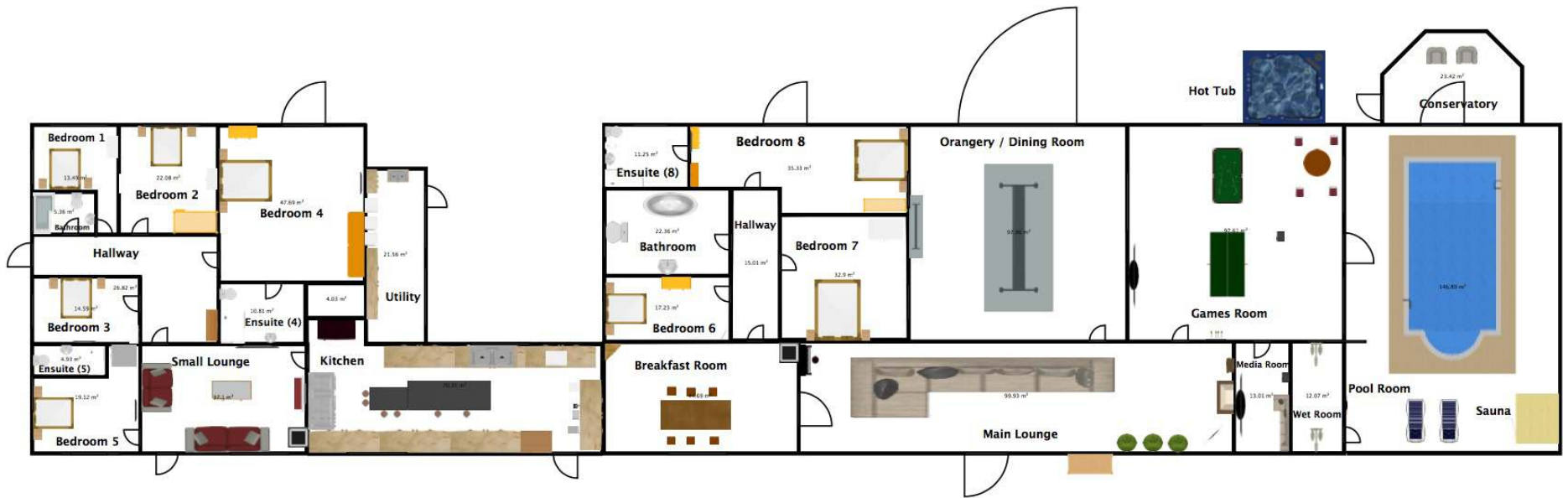

Brookway Lodge Floor Plan





Brookway Lodge 3D Plan





Bedroom Wing 1:

Bedroom 1: Double or Twin (Sleeps 2)

Bedroom 2: Double bed with Triple bed (Double bed with single bunk above) (Sleeps 5)

Bedroom 3: 2 x adult twins which *can be made to a double*, Smart TV (Sleeps 2)

Bedroom 4: Master Super King with en-suite shower, 50" TV with full sky package (Sleeps 2)

Bedroom 5: Double bed or 2 x Singles, with 39" LED Smart TV, this room has its own en-suite shower (Sleeps 2)

Bedroom Wing 2:

Bedroom 6: Triple bed (Double bed with single bunk above), TV (Sleeps 3)

Bedroom 7: Double or Twin (Sleeps 2)

Bedroom 8: Superking double which *can be split* into 2 x singles, also separate alcove room with 2 x adult bunk beds. En-suite shower and bidet / Smart TV (Sleeps 4)